



**t:slim X2™**  
Insulin Pump

## How to correctly disconnect from your pump

Disconnect from your pump at your site and not at the cartridge to prevent any air bubbles in your tubing.

**Can you see air bubbles or spaces in the tubing?**

1. Disconnect tubing from infusion site.
2. Fill tubing with insulin to expel air.
3. Reattach tubing to infusion set.
4. Resume insulin delivery.

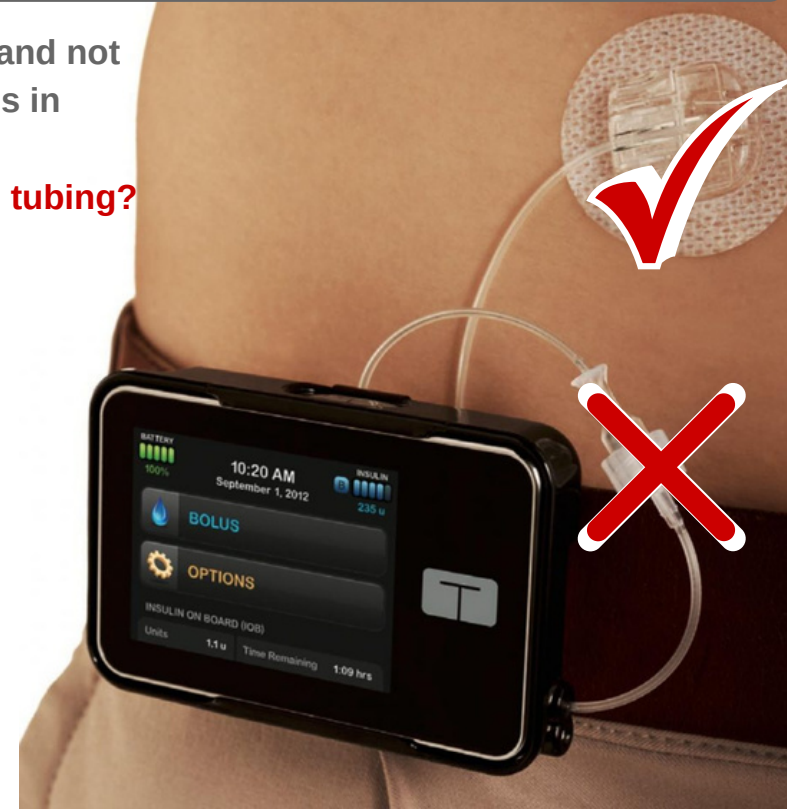

## MONTHLY CONSUMABLE ORDERS MADE EASY

Request a recurring standard monthly delivery of your Tandem and Dexcom consumables from the following pharmacies:



012 426 4535  
diabetes@medipost.co.za



011 712 6000  
063 101 0911 (WhatsApp)  
brianm@cdediabetes.co.za

Remember to provide the product name, quantity and NAPPI code to the pharmacy.

Our Customer Service Team remain available to you via the Customer Service number 0861 339 266 for any Tandem insulin pump related concerns or troubleshooting